

NeoFlow<sup>®</sup>

It's the little things...

Neonatal CPAP solutions



# FROM OUR HANDS...

**Armstrong Medical provides comprehensive circuitry solutions for delivering nCPAP in your NICU. Our NeoFlow® nCPAP kit solutions consolidate everything you require into a convenient pack, offering an excellent choice to streamline care, minimise waste, and facilitate seamless transitions between respiratory therapies.**

All our NeoFlow® nCPAP kit solutions are designed for easy set up and efficient delivery of respiratory support to neonatal patients.

- Options for ventilator CPAP, Bubble CPAP and variable flow nCPAP
- Versatile design to meet the changing respiratory needs of babies in NICU
- Cable management clips enhance safety and promote a positive experience for parents
- Compatible range of accessories and interfaces further optimise respiratory therapies
- Breathing circuits contain BioCote® antimicrobial protection as standard



# ...TO YOURS

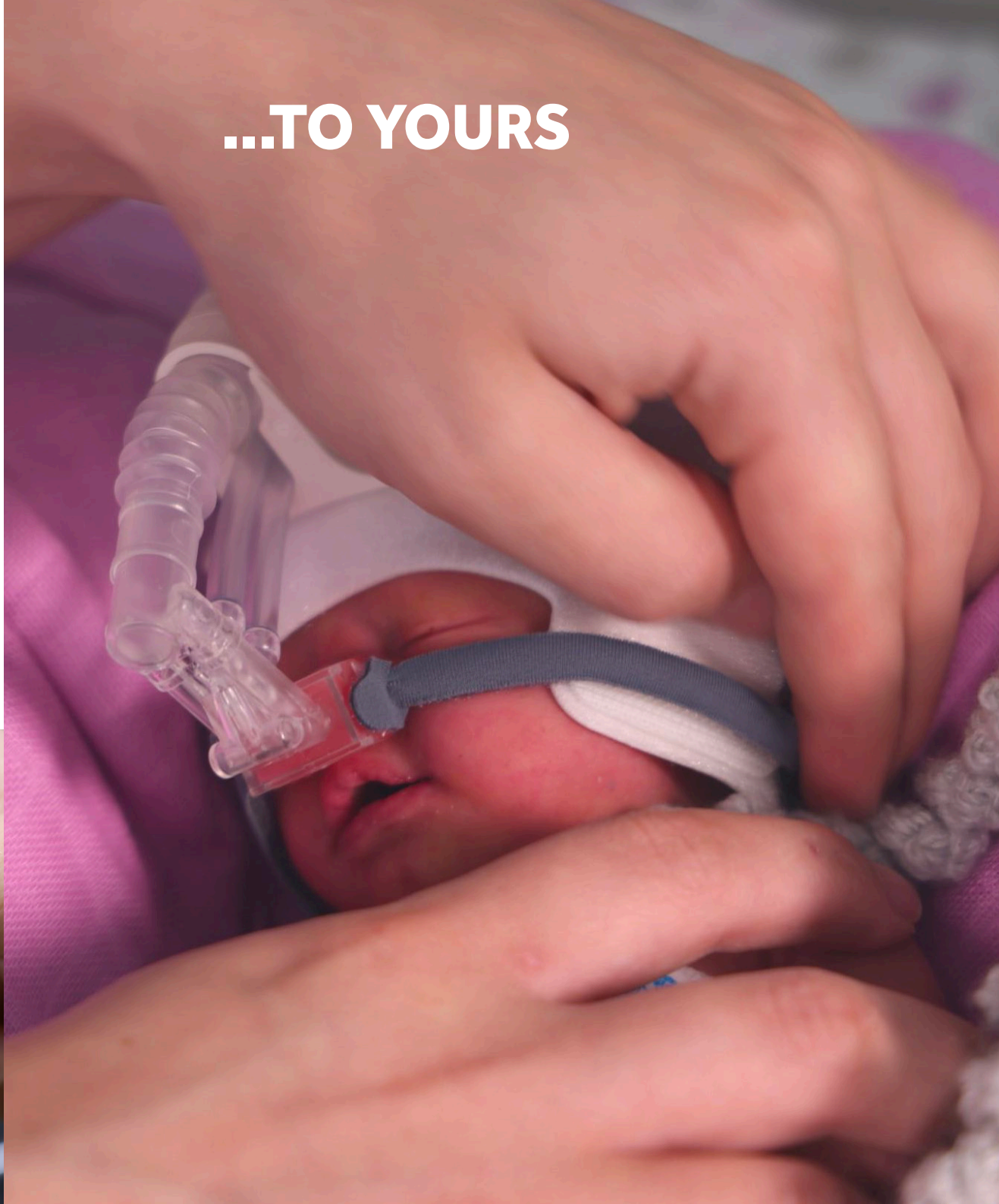



# CONTINUOUS-FLOW CPAP

## Ventilator CPAP



NeoFlow® circuits for ventilator-derived CPAP offer great versatility, thanks to our NeoFlow® VT option. This enables smooth weaning from mechanical ventilation to CPAP and then to High Flow Oxygen Therapy. Through the implementation of VT technology, the expiratory limb remains free from condensed water whilst ensuring no loss of gas volume. The NeoFlow® VT circuit, available with adaptors for most ventilators, and suitable for use with various dual limb interfaces, is perfect for accompanying the baby throughout their respiratory journey.

Code	Description	Box Qty	Pallet Qty
AMVC1775-204	<ul style="list-style-type: none"> <li>NeoFlow® VT ventilator circuit</li> <li>Dual limb heated for use with '850' series heater humidifier</li> <li>Length 1.35m with heated inspiratory and expiratory limbs</li> <li>Pressure line assembly</li> <li>Humidification limb length 0.6m</li> <li>Auto-fill humidification chamber</li> <li>Nitric oxide delivery kit and adaptors</li> </ul>	20	240



## Bubble CPAP



The NeoFlow® Bubble CPAP system provides a safe, consistent and accurate method of delivering humidified respiratory support to spontaneously breathing neonates. The bubbling effect created with our circuit and bubble generator jar delivers gentle pressure oscillations which can be beneficial in enhancing gas exchange and CO<sub>2</sub> elimination. Bubble CPAP, can be delivered via a blender option or AquaVENT® FD140i.

Code	Description	Box Qty	Pallet Qty
AMCP1408-003	<ul style="list-style-type: none"> <li>Single limb heated for use with '850' series heater humidifier</li> <li>Length 1.35m heated inspiratory limb</li> <li>Pressure line assembly</li> <li>Humidification limb length 0.6m</li> <li>Auto-fill humidification chamber</li> <li>Bubble valve assembly</li> </ul>	20	240



# VARIABLE-FLOW CPAP

## Variable flow nCPAP kit solutions

NeoFlow® variable flow nCPAP kits offer compatibility with a wide range of flow drivers, eliminating the requirement to keep multiple circuit variations in stock. This adaptability streamlines inventory management and reduces storage needs.



Adaptors\* are also available to fit:

- Acutronic
- Vyaire
- SLE/Inspiration Healthcare
- MEDIN Medical
- Dräger
- GE Healthcare
- Hamilton
- Stephan

\*list non-exhaustive

# DISCOVER THE RIGHT nCPAP KIT FOR YOUR NICU

Providing everything you need in one convenient kit

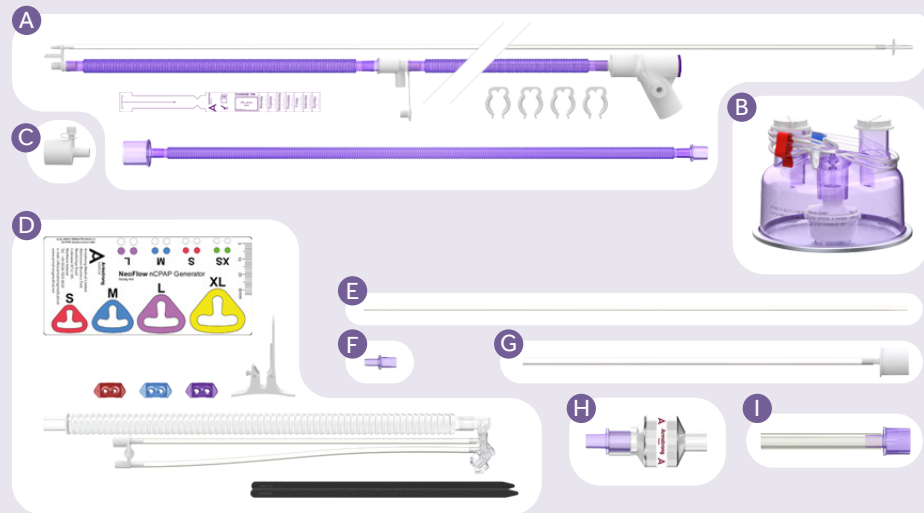

- A** Tubing limb and heated inspiratory limb with pressure line and cable management clips
- B** Humidification chamber
- C** Nitric oxide ports
- D** nCPAP generator set
- E** Additional pressure line
- F** Nasal cannula connector
- G** Fabian® limb
- H** nCPAP silencer
- I** SLE connector

Code	Description	Box Qty	Kit Includes
AMCP600-002	<ul style="list-style-type: none"> <li>• NeoFlow® nCPAP generator set with cradle</li> <li>• Small, medium and large nasal prongs</li> </ul>	20	D

Code	Description	Box Qty	Kit Includes
AMCP1409-044	Infant Flow®/SiPAP™ complete kit	20	A,B,D,H
AMCP1409-078	Infant Flow®/SiPAP™ kit without generator set	20	A,B,H
AMCP1409-049	Infant Flow®/SiPAP™ kit without chamber and silencer	20	A,D
AMCP1409-073	Infant Flow®/SiPAP™ kit without silencer	20	A,B,D
AMCP1409-037	Infant Flow®/SiPAP™ and Fabian® nCPAP complete kit	20	A,B,D,E,F,G,H
AMCP1409-031	Infant Flow®/SiPAP™ and Fabian® nCPAP complete kit with nitric ports	20	A,B,C,D,E,F,G,H
AMCP1409-072	Infant Flow®/SiPAP™ and Fabian® nCPAP kit without generator set	20	A,B,E,F,G,H
AMCP1409-094	Infant Flow®/SiPAP™ and Fabian® nCPAP kit without chamber and silencer	20	A,D,E,F,G
AMCP1409-057	SLE nCPAP and HFOT kit without silencer with nitric ports	20	A,B,C,D,F,I

## It's the little things, like...

### BioCote® antimicrobial protection as standard









All our NeoFlow® nCPAP circuits include BioCote® antimicrobial protection as standard. Designed to provide durable and long-lasting protection, BioCote® complements existing hygiene practices by providing an additional layer of defence against microbial contamination, providing peace of mind to families and caregivers.

### Ultra soft bonnets that grow with baby



Experience the exceptional stability and versatility of our NeoFlow® nCPAP bonnet, available in six different sizes. Designed to enhance skin-to-skin contact, the bonnet allows for direct access to the top of the head, facilitating seamless procedures while ensuring maximum comfort for babies in neonatal care.

Code	Description	Case Qty
AMBT100-XXS	 Bonnet, pre-term (light blue) - up to 24cm	20
AMBT100-XS	 Bonnet, extra small (white) - 24-28cm	20
AMBT100-S	 Bonnet, small (yellow) - 28-31cm	20
AMBT100-M	 Bonnet, medium (purple) - 31-34cm	20
AMBT100-L	 Bonnet, large (green) - 34-38cm	20
AMBT100-XL	 Bonnet, extra-large (pink) - 38-42cm	20



Part of



#### Armstrong Medical

Wattstown Business Park, Newbridge Road,  
Coleraine, BT52 1BS, Northern Ireland.

T +44 (0) 28 7035 6029

info@armstrongmedical.net



armstrongmedical.net